

PRORIL

50 Hz

GOVOX Series, these vortex pumps feature a less impeller wear and longer pump life by a vortex flow that allows fibrous materials and solid matters to be pumped out without obstruction.



Sewage Pump

GOVOX-U 337

Vortex Pump

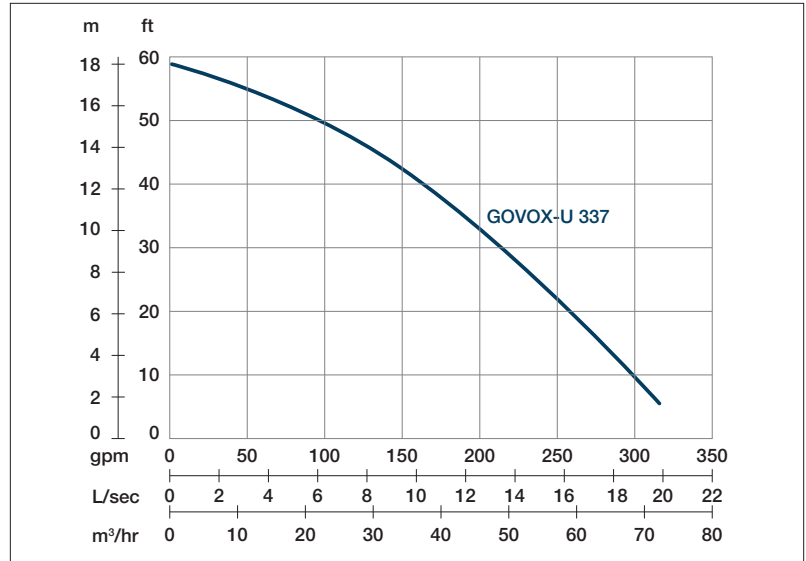

Shaft Speed : 2850 rpm Solid Passage : 55 mm Outlet : 80mm, 3in

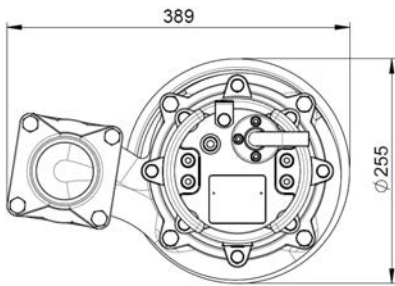

| OUTPUT | HEAD | FLOW |
|--------|-------------------|--------------------------|
| 3.7 kW | Rated : 15m, 49ft | Rated : 7.5 l/s, 119 gpm |
| 5 HP | Max : 18m, 59ft | Max : 20 l/s, 317 gpm |

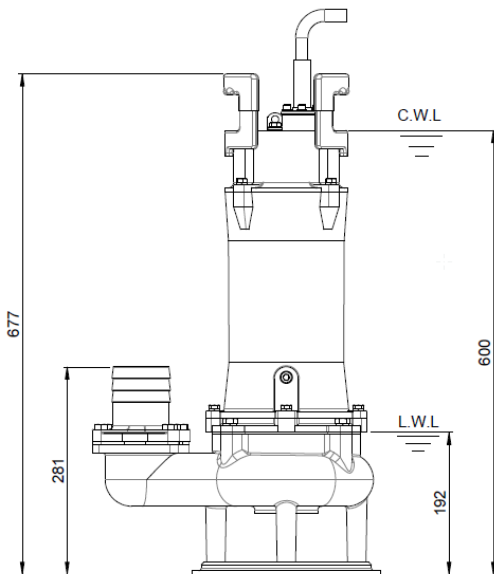

Weight: 49,7kg / 109lbs

| | | |
|-------------------------|-------------|--|
| Pump Type | | Electric Submersible Pumps |
| | | 3-Phase |
| Motor | Type | Induction Motor |
| | Poles | 2 Pole |
| | Insulation | Class F |
| | Protector | Circle Thermal Protector |
| | Starter | D.O.L. |
| Lubricant | | Food Grade (ISO VG32) |
| Impeller Type | | Vortex |
| Shaft Seal | | Double Mechanical Seal |
| | | Silicon Carbide VS Ceramic / Carbon |
| Bearings | | C3 Shielded ball bearings |
| Cable | | H07RNF |
| | | Length: 10m (33ft) or longer upon request. |
| Materials | Pump Casing | Gray Iron |
| | Impeller | Gray Iron |
| | Motor Frame | Gray Iron |
| | Motor Shaft | Stainless Steel |
| Max. Liquid Temperature | | 104°F (40°C) |
| Max. Submersion Depth | | 66ft (20m) |
| pH Range | | pH 5 - pH 8 |